

## Development Proposal

Presentation material for the  
Anderson Development  
proposal for office  
campus/hotel  
"The Heart of The City"  
Burnsville, MN

September 10, 2007



In collaboration with:



# Schedule Assumptions

Delivery of Property by City 05/08  
Property Closing - Sale to AD 05/08

## Shared Parking Deck Facility (Deck - Phase 1)

Construction Start 05/08 – 6/08  
Occupancy of Deck 12/08

## East Building (Office – Phase 1)

Construction Start 06/08 – 08/08  
Occupancy of Building 08/09 – 10/09

## Restaurant/Event Facility/Hotel

Construction Start 06/08 – 08/08  
Occupancy 08/09 – 10/09

## West Building (Office – Phase 2)

Construction Start (projected) 05/11 – 08/11  
Occupancy of Building 09/12 – 12/12

## Deck – Phase 2

Deck capacity As determined by market conditions  
Construction Start/Completion As determined by Phase 2 office

Highway 13

Pillsbury Avenue

West Travelers Trail

Nicollet Avenue

126th Street

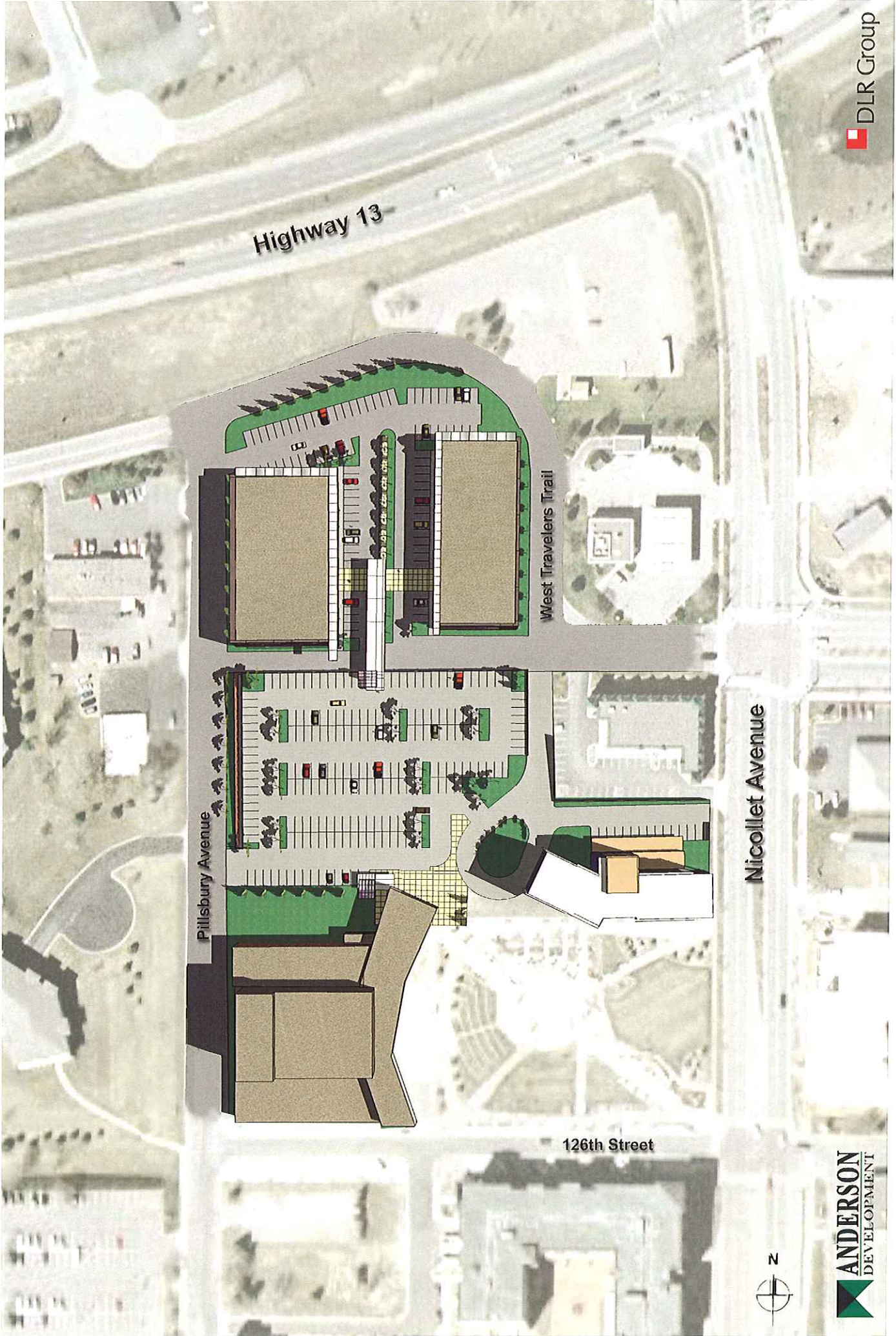





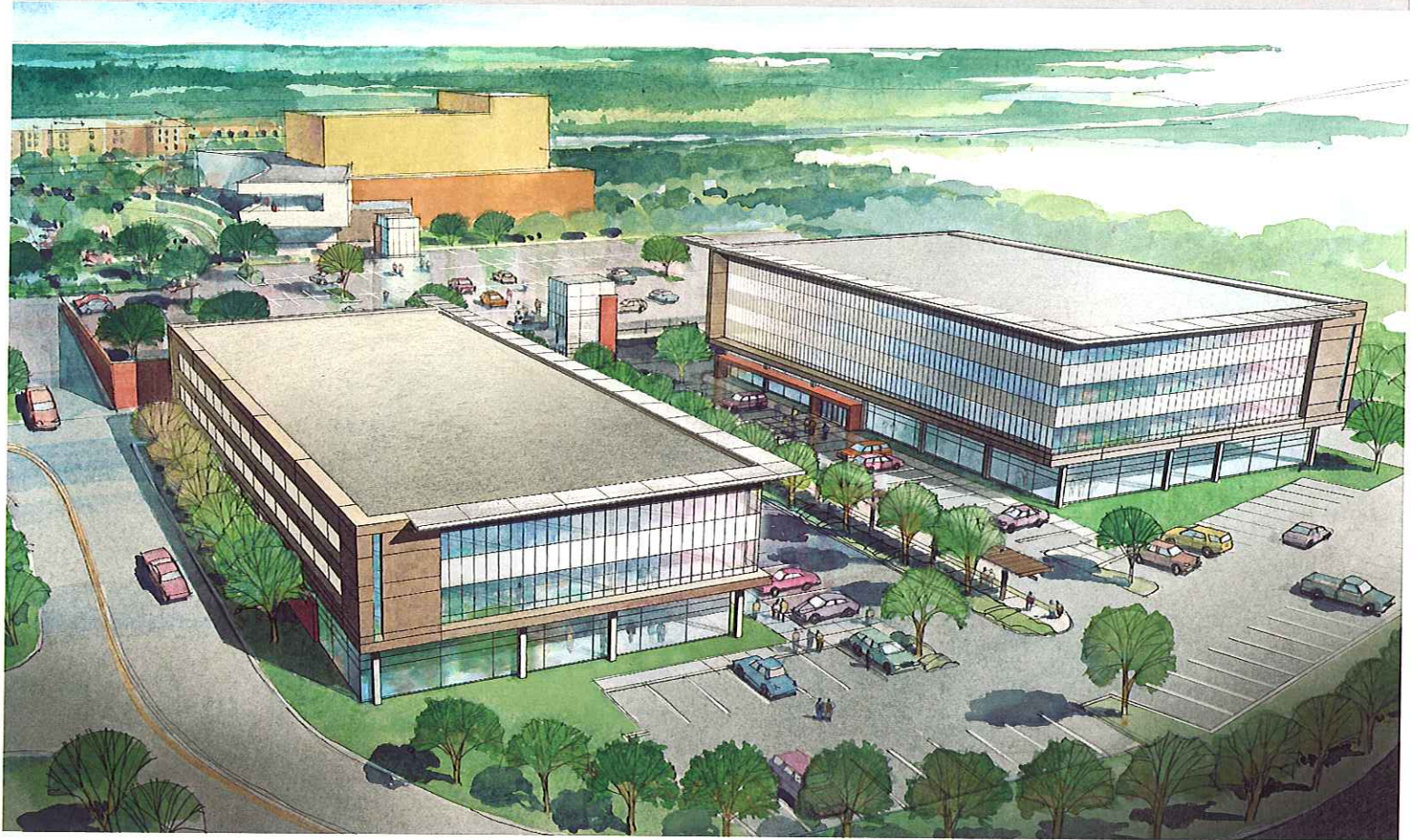

**Thank You!**

Contact: Dave or Greg Anderson  
Anderson Development  
355 Louisiana Ave S  
St. Louis Park, MN 55426  
Phone: 952.927.5400



In collaboration with:

